

**Series 8, Heat pump tumble dryer, 9 kg  
WQB246C9GB**

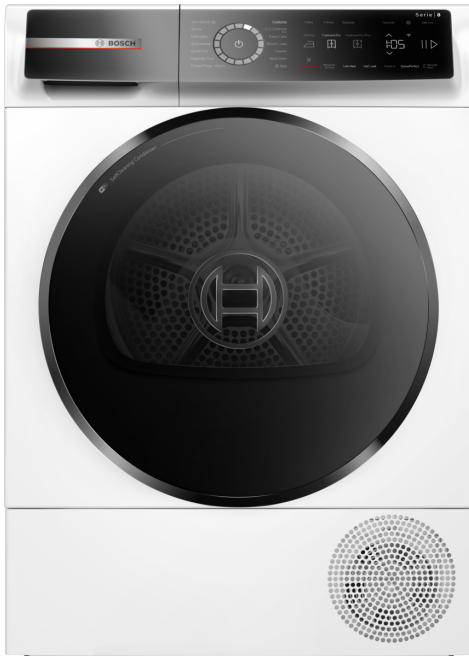

**A+++**



- WMZ20600 Wool in basket - accessory
- WTZ27500 Stacking kit with pull-out shelf
- WTZ27510 Stacking kit
- WTZPW20D Platform with pull-out, dryer, cubic

**An exceptional heatpump dryer with Smart Dry powered by Home Connect. Maximise your energy savings with A+++ -10%\* and the Self Cleaning condenser. Protect your Garments with Auto Dry and reduce your ironing Pile with Iron Assist.**

- **Auto Dry:** automatically senses when your preferred level is reached.
- **SelfCleaning Condenser:** keep the condenser free of fluff to maintain top A+++ energy efficiency.
- **Smart Dry:** your dryer connects to your washer to recommend the right drying programme.
- **Home Connect:** smart appliances with enhanced connectivity for an easier life.
- **Home Connect:** smart energy management for your tumble dryer.

---

Built-in / Free-standing: ..... Freestanding  
 Removable top: ..... No  
 Door hinge: ..... Right reversible  
 Length electrical supply cord: ..... 180.0 cm  
 Dimensions: ..... 842x598x613 mm  
 Net weight: ..... 55.2 kg  
 Fluorinated greenhouse gases: ..... No  
 Type of refrigerant: ..... R290  
 Hermetically sealed equipment: ..... Yes  
 EAN code: ..... 4242005364428  
 Connection rating: ..... 600 W  
 Fuse protection: ..... 10 A  
 Voltage: ..... 220-240 V  
 Frequency: ..... 50 Hz  
 Loading capacity: ..... 9.0 kg  
 Energy efficiency rating: ..... A+++  
 Energy consumption electric dryer, full load - NEW (2010/30/EC): 1.44 kWh  
 Standard cotton programme time at full load: ..... 260 min  
 Energy consumption electric dryer, partial load - NEW (2010/30/EC): ..... 0.80 kWh  
 Standard cotton programme time at partial load: ..... 156 min  
 Weighted annual energy consumption, electric dryer - NEW (2010/30/EC): ..... 174.0 kWh/annum  
 Weighted programme time: ..... 201 min  
 Average condensation efficiency full load (%): ..... 91 %  
 Average condensation efficiency partial load (%): ..... 91 %  
 Weighted condensation efficiency (%): ..... 91 %



## Series 8, Heat pump tumble dryer, 9 kg WQB246C9GB

**An exceptional heatpump dryer with Smart Dry powered by Home Connect. Maximise your energy savings with A+++ -10%\* and the Self Cleaning condenser. Protect your Garments with Auto Dry and reduce your ironing Pile with Iron Assist.**

- Appliance depth with open door: 110.5 cm
- Heat pump technology with climate friendly cooling agent

<sup>1</sup> At a range of energy efficiency classes from A+++ to D

<sup>3</sup> Programme time of the standard cotton programme at full load

<sup>4</sup> On a condensation efficiency class scale from A to G

<sup>5</sup> Weighted condensation efficiency for the standard cotton programme at full and partial load

### Performance

- Energy Efficiency Class<sup>1</sup>: A+++
- 10% more efficient than energy efficiency class A+++\*\*
- Energy<sup>2</sup>: 174 kWh
- Capacity: 1 - 9 kg
- Programme time<sup>3</sup>: 260 min
- Noise level: 58 dB (A) re 1 pW
- Condensation efficiency class<sup>4</sup>: A
- Condensation efficiency<sup>5</sup>: 91 %

### Programmes/functions

- Standard programmes: cotton, easy care
- Special programmes: Cottons, Shirts/blouses, Cotton Eco, Delicates, Towels, Mixed Load, Sportswear, Easy-Care, Timed programme warm

### Key features

- Half Load option: optimises drying for smaller loads
- Anti crease cycle 120 min at the end of the programme
- Touch control buttons: Iron dry, Cupboard dry, Cupboard dry+, end Time Delay, Reduced ironing, My favorite, Power button, Remote Start, Low heat, Start / Reload / Pause, speedPerfect, 24 h end Time Delay

### Additional features

- SC1R
- Load recommendation
- Fully electronic control dial for sensor programmes and timed programmes
- Sensitive drying: large stainless steel drum with textile care and revolution drying system
- AntiVibration design: for greater stability and quietness
- No
- Drum interior light
- Container for condensed water
- Child lock
- Buzzer to indicate the end of cycle
- Usage meter: counts completed programmes
- Door hinge: right-hand, reversible
- Metal door catch

### Technical Information

- slide-under installation
- Dimensions (H x W): 84.2 cm x 59.8 cm
- Appliance depth: 61.3 cm
- Appliance depth incl. door: 65.1 cm

**Series 8, Heat pump tumble dryer, 9  
kg  
WQB246C9GB**

Measurements in mm

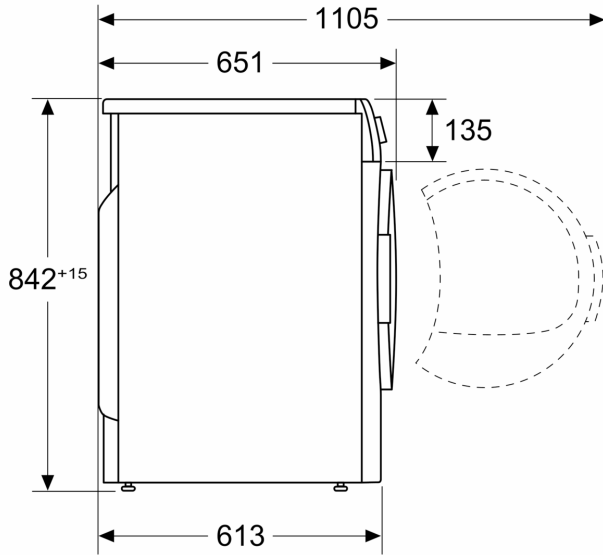

Measurements in mm

